

Diabetes Updater app

Re-pairing your Roche® Accu-Chek® Guide Link meter and Guardian™ Link (3) transmitter after an update

This guide will take you through re-pairing your Roche® Accu-Chek® Guide Link BG meter and your Guardian™ Link (3) transmitter with your updated MiniMed™ 780G pump after using the Diabetes Updater app.

Pairing the Accu-Check Guide meter



1. Press the **OK** button on the meter to turn it on.
2. Select **Settings** then **Wireless**.



3. Select **Pairing**, then **Delete pairing**. You will see your pump serial number on the screen, then select and delete it.
4. Select **Pair to Pump**, if not automatically displayed, then select **Yes**.



The meter serial number appears on the meter screen. **The meter is now ready to pair with the pump.**

1. From the home screen press  and then select .



2. Select **Pair New Device**. The Searching screen appears. After the pump is done searching, the Select Device screen appears



3. Select the meter that matches the serial number that displays on the meter screen. If the correct serial number does not appear, select **Search Again**.



4. If the serial numbers shown on the pump screen and meter screen match, select **Confirm**. Press  if the serial number is incorrect.



If the connection is successful, a "Pairing successful!" message appears on the pump. A "Paired with pump" message with the serial number of the pump appears on the meter screen.



Turn over for instructions on how to pair your Guardian™ Link (3) transmitter

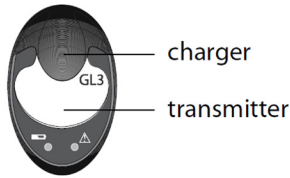

Pairing the Guardian™ Link (3) transmitter

1. Attach the transmitter to the charger.



2. On your pump, from the Home screen, press  and then select .



3. Place the transmitter (still attached to charger) next to the pump.



4. Select **Pair New Device**. The Searching screen appears



5. Remove the transmitter from the charger. The transmitter light flashes 10 times and turns off. The **Select Device** screen appears with a list of available devices.

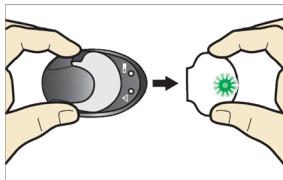

6. Select the CGM device that matches the serial number indicated on the back of the transmitter.

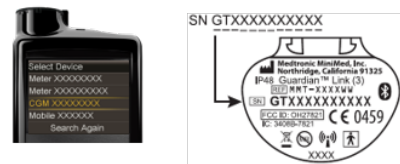

7. If the transmitter serial number on the pump screen matches the serial number on the back of the transmitter, select **Confirm**. Press  if the serial number is incorrect.

If the connection is successful, a "Pairing successful!" message appears on the pump.



Important safety information

The MiniMed™ 780G insulin pump is indicated for use by patients age 7-80 years with Type 1 diabetes, whose total daily dose of insulin is 8 units per day or more. The MiniMed™ 780G system is intended for the continuous delivery of basal insulin at selectable rates and the administration of insulin boluses at selectable amounts. The system is also intended to continuously monitor glucose values in the fluid under the skin. The MiniMed™ 780G system includes SmartGuard™ technology, which can be programmed to provide an automatic adjustment of insulin delivery based on continuous glucose monitoring (CGM) and can suspend the delivery of insulin when the sensor glucose (SG) value falls below, or is predicted to fall below, predefined threshold values.

The Medtronic MiniMed™ 780G system consists of the following devices: MiniMed™ 780G Insulin Pump, the Guardian™ Link (3) Transmitter, the Guardian™ Sensor (3), One-press Serter, and the Accu-Chek® Guide Link meter. The Guardian™ Sensor (3) is required for CGM. The Guardian Sensor (3) glucose sensor is the only sensor compatible with the MiniMed™ 780G insulin pump and Guardian Link (3) transmitter.

Always use the fingertip for blood samples intended for sensor calibration. Blood samples from other locations, such as the palm or forearm, have not been studied, and the accuracy of these samples is unknown. Pump technology is not recommended for people whose vision or hearing does not allow for the recognition of pump signals, alerts, or alarms. Pump technology is not recommended for people who are unwilling or unable to maintain contact with their healthcare professional.

The safety of the MiniMed™ 780G system has not been studied in pregnant women, persons with type 2 diabetes, or in persons using other anti-hyperglycemic therapies that do not include insulin. The performance of the Guardian Sensor (3) has not been evaluated for pregnant women or persons on dialysis. For complete details of the system, including product and important safety information such as indications, contraindications, warnings and precautions associated with the system and its components, please consult the appropriate user guide.

Warning: Do not use SG values to make therapy treatment decisions while the pump is in Manual mode. SG values can only be used to make therapy treatment decisions while the SmartGuard feature is active. These therapy decisions using SG refer only to boluses and Auto correction boluses while the SmartGuard feature is active. SG and BG values may differ. If the SG reading is low or high, or there are symptoms of low or high glucose, confirm the SG reading with a BG meter prior to making therapy decisions to avoid hypoglycemia or hyperglycemia.

©2022 Medtronic. All rights reserved. Medtronic, Medtronic logo and Engineering the extraordinary are trademarks of Medtronic. TM*Third party brands are trademarks of their respective owners. All other brands are trademarks of a Medtronic company. CA-DIB-0127-E Rev. 11/2022



Medtronic