

Signia™ Adapter

Manual operation quick use guide

Linear adapter

Precaution: Attempt to use the powered opening procedure, handle reboot, and backup handle before attempting to manually operate any Signia™ adapter.

Observe: The center drive mechanism, marked with an embossed circle and clockwise arrow, controls **clamping/unclamping** and **firing/retracting**.

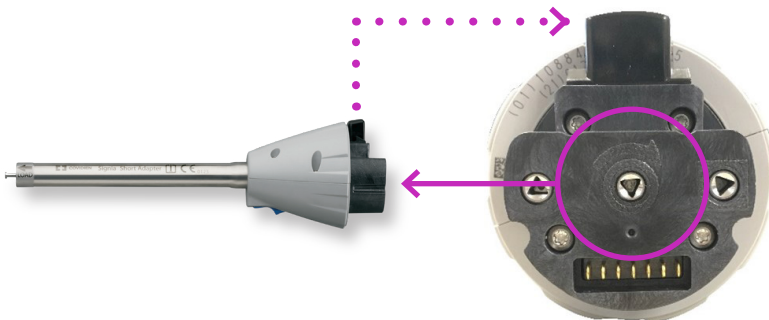

Discover more at

[medtronic.com/
signia-linear](https://medtronic.com/signia-linear)

[medtronic.com/
signia-circular](https://medtronic.com/signia-circular)

1 To manually open or retract (post-firing):

Open reload or retract knife by rotating center drive clockwise.

Note: Manually operating the linear adapter **may take several minutes and more than 100 rotations** of the tool depending on position of firing mechanism at time of failure.

Stop when sudden resistance is felt. **Do not overtighten** at distal end of staple line. Damage to adapter may result in inability to retract and open.

2 (Optional) To manually complete firing:

Complete a firing by rotating the center drive counterclockwise.

3 (Optional) Manual articulation:

Rotate the third drive either clockwise or counterclockwise depending on desired direction of articulation.



Refer to instructions for use

Circular adapter

Precaution: Attempt to use the powered opening procedure, handle reboot, and backup handle before attempting to manually operate any Signia™ adapter.

Observe: The #1 drive controls the knife and the #2 (center) drive controls trocar position for clamping and unclamping.

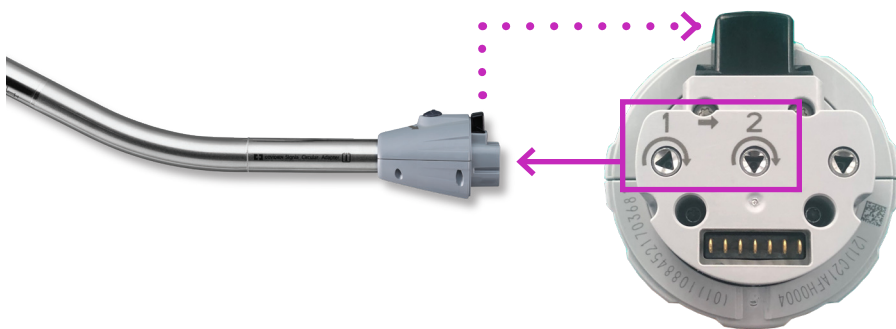

Note: Manually operating the circular adapter may take several minutes and more than 100 rotations of the tool depending on position of knife and trocar spike at time of failure.

Stop when sudden resistance is felt. **Do not overtighten any drive.** Damage to internal drive mechanisms may result in difficulty or inability to open..

Visit
medtronic.com/signia-circular
for In-Service
video

1

Ensure knife is retracted:

Retract knife (Drive 1: clockwise) until resistance is met.

2

To manually open:

Open reload (Drive 2: clockwise) and remove anvil.

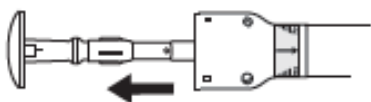

3

Retract spike:

Retract spike (Drive 2: counterclockwise) until resistance is met.

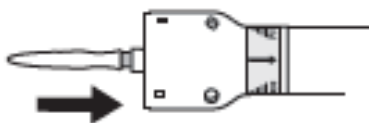

Refer to instructions for use

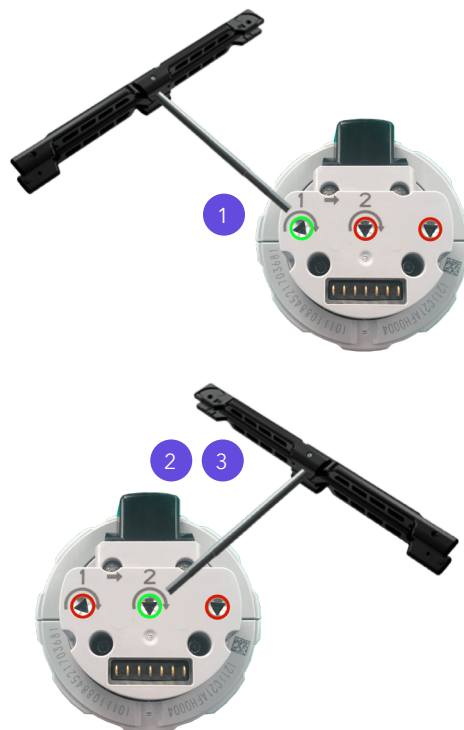

Manufactured for Covidien Inc, 15 Hampshire Street, Mansfield, MA 02048 USA.

©2025 Medtronic. Medtronic, Medtronic logo, and Engineering the extraordinary are trademarks of Medtronic. All other brands are trademarks of a Medtronic company. 07/2025 - US-ST-2500047 - [WF#15970423]

medtronic.com

Medtronic