

Medtronic

Quick Reference Guide

Puritan Bennett™ cuff pressure manager

The Puritan Bennett™ cuff pressure manager (CPM) continuously measures and automatically maintains cuff pressures in ventilated patients.



It's designed to support cuffed endotracheal tubes or cuffed tracheostomy tubes for adult and pediatric patients in the following sizes:

Cuffed endotracheal tubes:

sizes 3 - 10
(inner diameter)

Cuffed tracheostomy tubes:

sizes 2.5 - 10
(inner diameter of outer cannula)

The essentials

Connect AC power

Connect extension tube

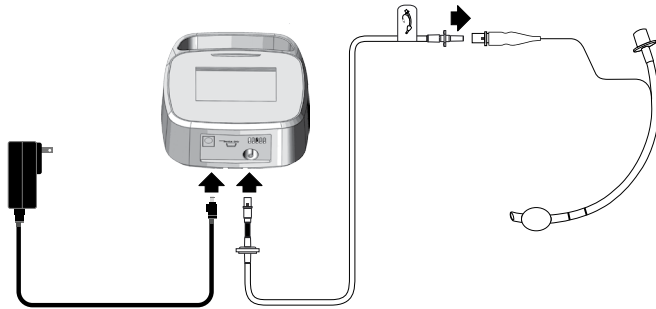

Turn on CPM

Press the **power button**. CPM will perform the power on self test (POST) and then enter **measure mode**. It **will not** regulate cuff pressure during this time.

Note: Internal battery charges when CPM is connected to AC power and unit is powered on.



Enter control mode to regulate cuff pressure to the target pressure: +/- 1 cmH₂O

Choose one of two options to enter **control mode**:



Press the **one-click inflate button** to adjust the cuff pressure to 25 cmH₂O

Press and hold the **decrease (-) or increase (+) button** to adjust the cuff pressure.

H appears when the target pressure is above 30 cmH₂O

L appears when the target pressure is below 20 cmH₂O

Lock and unlock control panel

Press the **lock button** to lock/unlock.



Mute an alarm

Press the **audio pause button** to mute an audible alarm for 2 minutes.

During alarm conditions, the control panel remains unlocked. The alarm will be muted for 2 minutes, unless a new alarm reactivates the alarm sound.

Deflate the cuff

1. Press and hold the **one-click deflate button** for at least 2 seconds. When deflation completes, CPM enters measure mode.

Note: The target pressure will display 0.



Tip: When the cuff is deflated, the indicator for the target pressure setting will appear gray and the pressure display is negative (usually <-10 cmH₂O).

2. Wait until cuff is completely deflated to extubate the patient.
3. Disconnect the extension tube from CPM.

Turn off CPM

Press and hold the **power button** for at least 2 seconds.



Other functions

Time-limited pressure hold (+ 5 cmH₂O for 5-30 minutes)

Recommended to prevent aspiration during oral cleaning, mucous suctioning, or assessing lung function with an elevated applied airway pressure.



Press the **pressure hold button**.

Timer counts down from 5 minutes by default, unless you change the set hold time.

Extend pressure hold time (5-30 minutes)

To set the pressure hold time:







1. Simultaneously press and hold the **mute and pressure hold buttons** after enabling time-limited pressure hold function.



2. Press the **decrease (-) or increase (+) button** to adjust hold time.



3. Simultaneously press the **mute and pressure hold buttons** to confirm and exit.

Alarm name	Alarm priority	Possible causes	Suggested actions
Low pressure 	High	<ul style="list-style-type: none"> • CPM is in measure mode and the measured cuff pressure is below 20 cmH₂O for more than 1 minute • CPM is in control mode and measured cuff pressure is 2 cmH₂O below set value +/-1 for more than 10 seconds 	<ul style="list-style-type: none"> • Make sure CPM is in control mode • Verify the connections and integrity of extension tube • Verify there is no cuff leak or inflation port leak • Verify CPM can deliver gas out <ul style="list-style-type: none"> – Disconnect the machine-end of extension tube – Use a finger to detect pressure at extension tube connector
High pressure 	High	<ul style="list-style-type: none"> • CPM is in measure mode and measured cuff pressure is above 30 cmH₂O for more than 1 minute • CPM is in control mode and measured cuff pressure is 2 cmH₂O above set value +/-1 for more than 30 seconds • Deflation time exceeds 30 seconds 	<ol style="list-style-type: none"> 1. Disconnect machine-end of extension tube 2. Use a finger to detect a vacuum at extension tube connector <ul style="list-style-type: none"> – If CPM is deflating the cuff for extubation, check the connection between extension tube and CPM. – Also check the connection between extension tube and endotracheal tube or tracheostomy tube.
Battery depleted 	High	<ul style="list-style-type: none"> • Battery is almost depleted when AC power is not connected with less than 30 minutes remaining 	<ul style="list-style-type: none"> • Immediately connect CPM to external AC power with CPM powered on
Battery very low 	Medium	<ul style="list-style-type: none"> • Very low battery when AC power is not connected with 2 to 5 hours of operating time remaining 	<ul style="list-style-type: none"> • Immediately connect CPM to external AC power
Technical error 	High	<ul style="list-style-type: none"> • Hardware error such as pressure sensor error or temperature sensor error • AC/DC adapter is faulty or a non-approved adapter 	<ul style="list-style-type: none"> • Power CPM off and back on • Replace if AC/DC adapter is faulty (part number PT00087967-SP)

Check the *Instructions for Use* for full instructions on how to operate your Puritan Bennett™ cuff pressure manager.

Important: Please refer to the package insert for complete instructions, contraindications, warnings and precautions.
© 2023 Medtronic. Medtronic, Medtronic logo, and Engineering the extraordinary are trademarks of Medtronic.
All other brands are trademarks of a Medtronic company. EMEA-RE-2300033-pb980-cuff-pressure-manager-quick-reference-guide-en-we-9393072